



BERING 85

BERING COASTAL SERIES

The Coastal series combines the trusted seakeeping abilities of the Bering brand with a contemporary appearance in the exterior and interior of each model.

Conceived by Bering Yachts naval architects with design services from SABDES Design, the Coastal series vessels (B70, B70 Tempest, B85, and B105) feature a steel semi-displacement hull and an aluminum superstructure. With the exception of B70 Tempest which is completely made out of aluminum.

Some of the innovative design aspects in the Coastal series include the efficient hull form and shallow draft, which permit all Coastal models to handle well in the shallow waters of the Caribbean and the Bahamas. These design attributes make these vessels equally ideal for coastal cruising in the Mediterranean.

Other trademarks of the Coastal series vessels are fuel efficiency, affordability, low maintenance, and ease of handling by a short-handed crew.

The plumb bow vessels of the Coastal series also feature streamlined styling and large, open deck layouts. The use of large glass panels allows the flow of natural light and unobstructed ocean views from the main deck. Similarly, the interiors reflect a minimalist and contemporary interior design aesthetic expressed through the use of unconventional fabrics and materials aimed to balance modern touches with warm and interesting features.





Designed for wave-piercing performance and smooth, fuel-efficient passage-making, Bering 85 features a streamlined styling and large, open deck layouts. Emphasis is placed on preserving natural light and providing unobstructed ocean views from as many angles on the yacht as possible. B85's hull design provides lower hull resistance, better performance and less slamming in choppy seas.

The Bering 85 has a top speed of 13 knots and a comfortable cruise speed of 8.5 knots. Underway, Bering 85's semi-displacement hull offers very comfortable cruises at all speeds, as well as superior stability as she breaks through the waves. She is timelessly elegant, combining practicality with a modern design.

Her fittings have a variety of functions and there are a large number of storage spaces. A well-balanced boat, it provides a unique feeling of safety and well-being.



In keeping with Bering's construction philosophy, the interior is fully customizable according to her owner's requirements. Bering designers work with each client individually, selecting the fabrics, appliances and galley fixtures that perfectly suit the intended interior styling theme. A wide selection of stone and synthetic counter surfaces can be chosen in addition to the flooring and cabinet materials. Likewise, the exact layout and location of furniture and cabinetry is subject to the owner's input.

The galley and saloon are located on the main deck creating a very attractive and comfortable living area. The lowered bulwarks allow for an amazing 360 view of the sea from the main deck while seated.

The accompanying layout renderings show just several of the stateroom options available to you. For example, the 85 can be configured with a really well-appointed master suite amidships with a luxurious and spacious en-suite head. The VIP is forward, and has en suite access to the VIP head divided to preserve toilet privacy. There is still enough space for two other symmetrical guest staterooms and crew quarters with extensive storage located in the aft side of the boat.

Steel yachts possess tremendous strength and rigidity so one is not limited by the fixed location of structural bulkheads when selecting layouts. This is just one reason why Bering chooses steel as their build material.

A huge sun pad on the bow deck allows for extensive sunbathing and relaxing with a glass of wine while enjoying the scenery underway. The open cockpit area also offers generous space and allows for alfresco dining and parties.

The flybridge is perfect for storing the tender and a powered davit. This area not only provides ample space for a steering station and all the typical displays and controls, but there's also plenty of room for a built in grill, sink and refrigeration units, as well as a large U-shaped settee.

The Bering 85 is designed with a displacement of 252,000 pounds (114 metric tons), carries 4,000 gallons (15,000 liters) of fuel and can cruise continuously for 3,500 miles without the need of refueling.



BRIEF SPECIFICATIONS BERING 85

Dimensions:

Length overall (LOA) – 85' (25.91 m)
 Length waterline (LWL) – 82'6" (25.19 m)
 Beam – 23'9" (7.29 m)
 Height – 30' (8.9 m)
 Draft – 4'5" (1.4 m)
 Displacement (114 metric tons) – 252,000 lbs.
 Gross tonnage – 129 GT

Construction:

Hull – Marine Grade "A" Steel
 Superstructure – Marine Grade Aluminum 5082

Tank Capacities:

Fuel – 4,000 gal. (15,000 L)
 Fresh water – 800 gal. (3,500 L)

Gray Water – 264 gal. (1,000 L)
 Black Water – 264 gal. (1,000 L)

Performance:

Engines – Cummins QSL 9
 Power – 2 x 410 HP
 Cruising speed – 8.5 knots
 Maximum speed – 13 knots
 Range – 3,500 nautical miles

Accommodation:

Passengers – 8
 Crew – 2

Classification:

CE certification class A open oceans no limits.

All values are preliminary until the final design is determined.

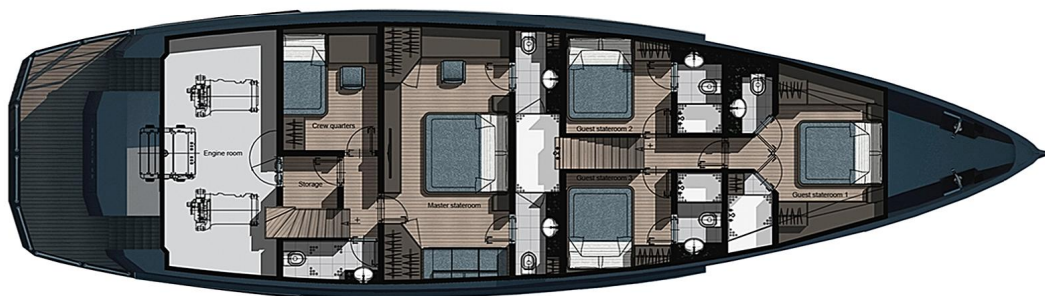
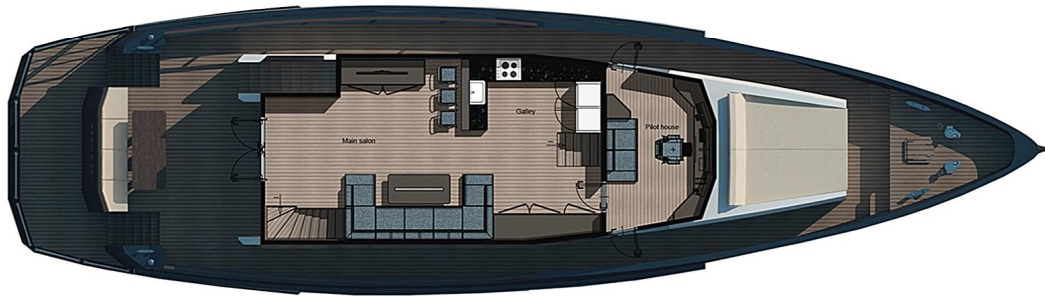
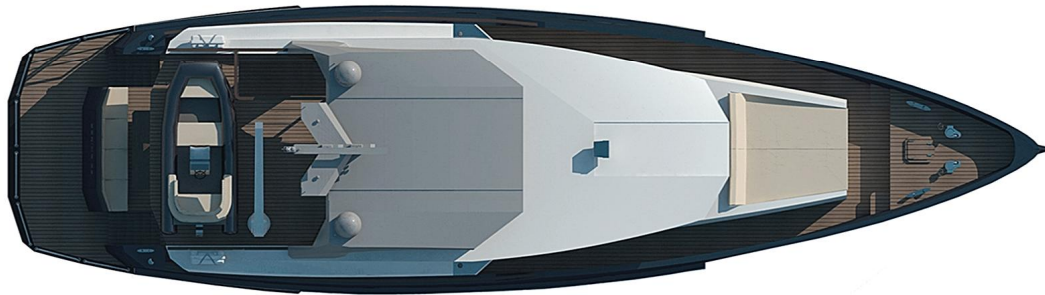



RALEIGH, 27613, NC, USA
WWW.BERINGYACHTS.COM